

LIQUADE®

EOM

Engineering Operation
& Maintenance

LIQUADE®

www.liquade.com

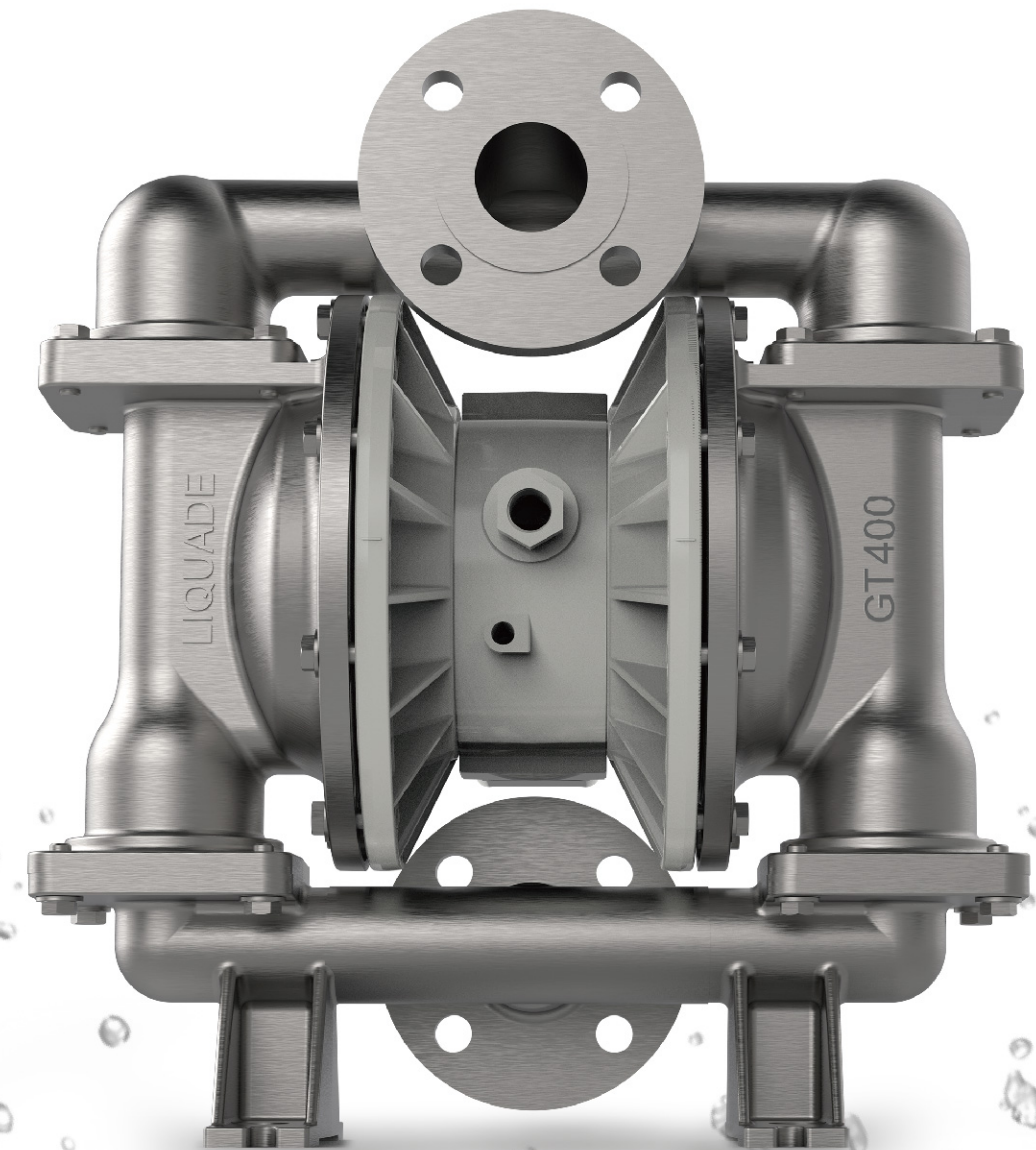

GT400
METAL Pumps



CONTENTS

SECTION 1 CAUTIONS

SECTION 2 PUMP DESIGNATION SYSTEM

SECTION 3 DIMENSIONAL DRAWING

SECTION 4 PERFORMANCE CURVES

GT400 METAL Rubber-Fitted

GT400 METAL TP-Fitted

GT400 METAL PTFE-Fitted

Suction Lift Curves

SECTION 5 SUGGESTED INSTALLATION

SECTION 6 TROUBLESHOOTING

SECTION 7 PUMP DISASSEMBLY

Pump Disassembly

Air Valve&Center Section Disassembly

Reassembly Hints & Tips

SECTION 8 EXPLODED VIEW & PARTS LISTING

GT400 METAL Exploded View

GT400 METAL Parts Listing

SECTION 9 ELASTOMER OPTIONS

! TEMPERATURE LIMITS:

Material	Temperature Limit (Celsius)	Temperature Limit (Fahrenheit)
Polypropylene	0°C to 79°C	+32°F to 175°F
PVDF	-12°C to 107°C	+10°F to 225°F
Santoprene	-40°C to 107.2°C	-40°F to +225°F
Neoprene	-17°C to 93.3°C	0°F to 200°F
BUNA	-12°C to 82°C	10°F to 180°F
VITON	-40°C to 176.7°C	-40°F to 350°F
EPDM	-51°C to 137.8°C	-60°F to 280°F
PTFE	-12°C to 107°C	+32°F to 175°F

CAUTIONS:

All wetted components have temperature limit, this must be taken in to consideration when selecting pump materials. For example: PTFE has a maximum limit of 104.4°C (220°F) but Polypropylene has a maximum limit of only 79°C (175°F).

- Maximum temperature limits are based upon mechanical stress only. Certain chemicals will significantly reduce maximum safe operating temperatures. Refer to engineering guide for chemical compatibility and temperature limits.

Diaphragm rupture might happen during pumping operation, this will result in the liquid being pumped to be force out of the air exhaust muffler. Therefore, it is important to wear safety glasses throughout the operation.

- Do not exceed 8.62 bar (125 psig) air supply pressure.
- Detach the compressed air line from the pump before carry out maintenance and repair as this helps to release all air pressure from the pump and follow by disconnect all suction, discharge and air line. Drain the pump by turning it upside down and allowing any fluids to flow into a suitable container.
- Blow out the air line for 10 to 20 seconds before connecting to pump to ensure all pipe lines are free from particles. Use an in-line air filter. A 5µ (micron) air filter is recommended.
- Check the chemical compatibility of the process and cleaning fluid to the material of the pump's component in the Chemical Resistance Guide.
- The GT400 pump is not submersible.

WARNING:

- Prevention of static sparking – Fire or explosion might take place if static sparking occurs. Thus, it is important to ground all pump, valves and containers when dealing with ignitable liquids and whenever discharge of static electricity is a hazard.

NOTES:

- Before starting disassembly, mark a line from each liquid chamber to its corresponding air chamber. This line will assist in proper alignment during reassembly.
- Fitting may loosen during transportation, it is always important to tighten the clamp bands and retainers before installation.
- -When installing PTFE diaphragms, it is important to tighten piston outer simultaneously (turning in opposite directions) to ensure tight fit.
- Plastic series pumps are made of virgin plastic and are not UV stabilized. Expose to direct sunlight for prolonged periods can cause deterioration of plastics.

SECTION 2

PUMP DESIGNATION SYSTEM

LIQUADE Pump Model Description Chart:

<u>GT400</u>	<u>S</u>	<u>P</u>	<u>P</u>	<u>T</u>	<u>T</u>	<u>S</u>	<u>XXX</u>
Model	Housing	Center Body	Air Valve	Diaphragms	Valve Ball	Valve Seat	Specialty

GT: Air-operated diaphragm pump, GT-Series

Model: Port size, 38mm (1.5")

Housing material:

S=STAINLESS

Center Body material:

P=POLYPROPYLENE
CP=CONDUCTIVE POLYPROPYLENE

Air Valve material:

P=POLYPROPYLENE
CP=CONDUCTIVE POLYPROPYLENE

Diaphragm material:

T=PTFE
N=NEOPRENE
W=SANTOPRENE
B=BUNA
V=VITON
E=EPDM

Valve Ball material:

T=PTFE
N=NEOPRENE
W=SANTOPRENE
B=BUNA
V=VITON
E=EPDM

Valve Seat material:

S=STAINLESS

SPECIALTY :

CH=PTFE coated hardware
AT=ATEX certificate
AF=ANSI flange
DF=Din flange
BT=BSPT thread
NT=NPT thread

SECTION 3

DIMENSIONAL DRAWINGS

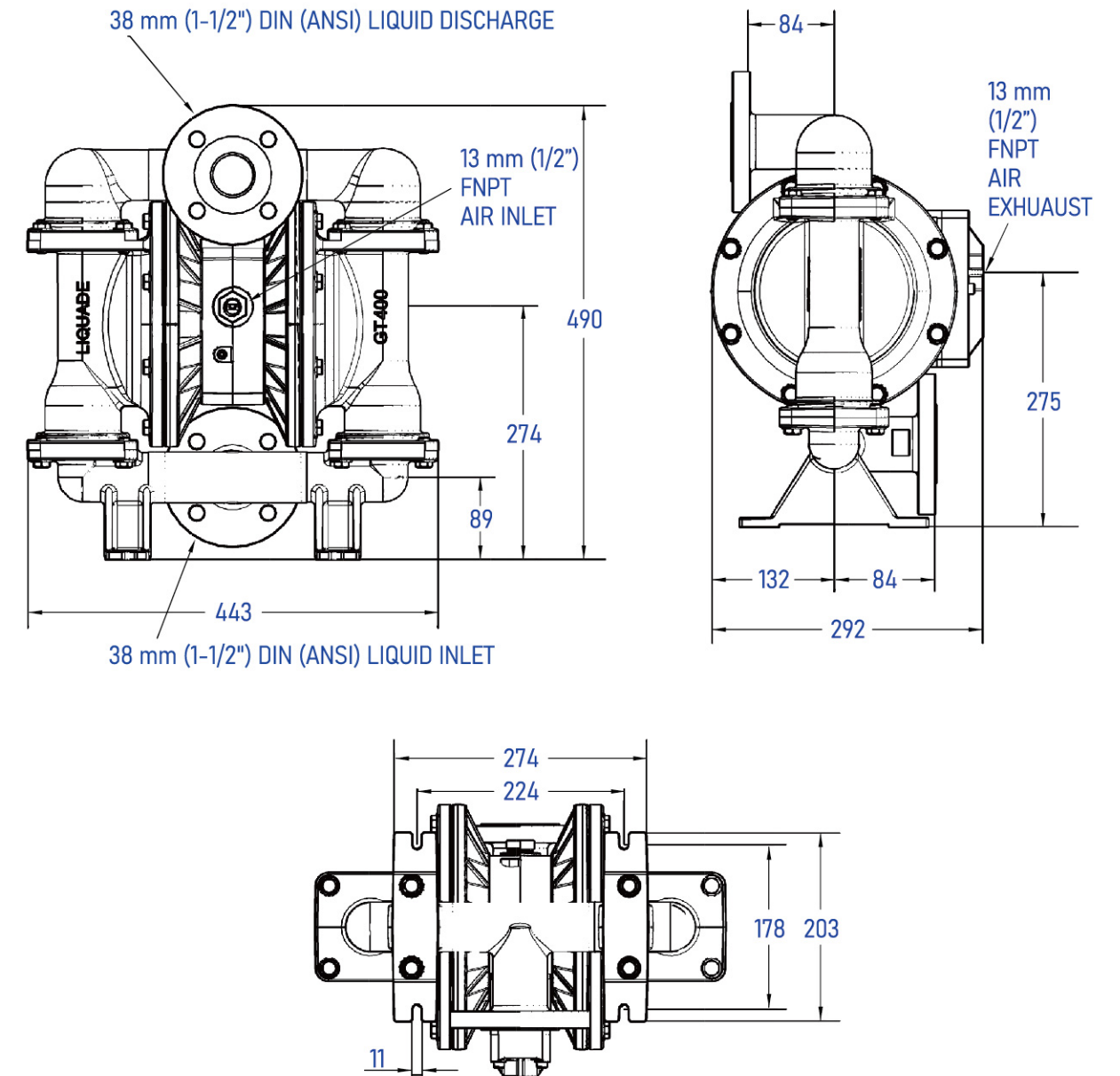

GT400 METAL RUBBER -FITTED

Height ----- 606 mm (24")
 Width ----- 442 mm (17")
 Depth ----- 203 mm (8")
 Est. Ship Weight
 ----- Threaded Stainless 49 kg (110 lbs)
 ----- Flanged Stainless 52 kg (105 lbs)
 Air Inlet ----- 19 mm (3/4")
 Inlet ----- 38 mm (1 1/2")
 Outlet ----- 38 mm (1 1/2")
 Suction Lift ----- 5.5 m Dry (18')
 ----- 9.0 m Wet (30')

Disp. Per Stroke
 ----- 1.2 l (0.32 gal.)¹
 Max. Flow Rate ----- 498 lpm (131 gpm)
 Max. Size Solids ----- 6.4 mm (3/16")

¹Displacement per stroke was calculated at 4.8 bar (70 psig) air inlet pressure against a 2 bar (30 psig) head pressure.

Example: To pump 160 lpm (40 gpm) against a discharge pressure head of 3.5 bar (50 psig) requires 4.2 bar (60 psig) and 50 Nm³/h (30 scfm) air consumption. (See dot on chart.)

Caution: Do not exceed 8.6 bar (125 psig) air supply pressure.

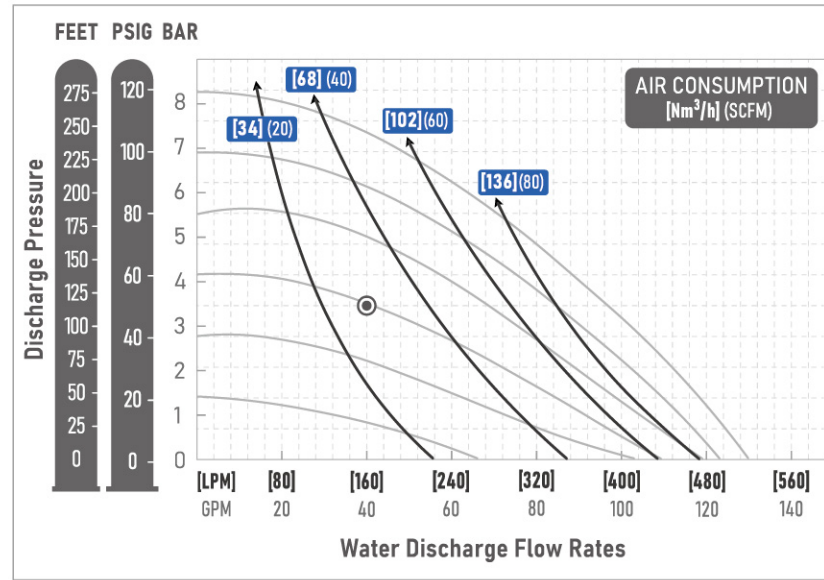

Flow rates indicated on chart were based on pumping water. For optimum life and performance, pumps should be specified so that daily operation parameters will fall in the center of the pump performance curve.

GT400 METAL TP -FITTED

Height ----- 606 mm (24")
 Width ----- 442 mm (17")
 Depth ----- 203 mm (8")
 Est. Ship Weight
 ----- Threaded Stainless 49 kg (110 lbs)
 ----- Flanged Stainless 52 kg (115 lbs)
 Air Inlet ----- 19 mm (3/4")
 Inlet ----- 38 mm (1 1/2")
 Outlet ----- 38 mm (1 1/2")
 Suction Lift ----- 4.9 m Dry (16')
 ----- 9.0 m Wet (30')

Disp. Per Stroke
 ----- 1.2 l (0.32 gal.)
 Max. Flow Rate ----- 490 lpm (130 gpm)
 Max. Size Solids ----- 6.4 mm (3/16")

Displacement per stroke was calculated at 4.8 bar (70 psig) air inlet pressure against a 2 bar (30 psig) head pressure.

Example: To pump 160 lpm (40 gpm) against a discharge pressure head of 3.5 bar (50 psig) requires 4.2 bar (60 psig) and 50 Nm³/h (30 scfm) air consumption. (See dot on chart.)

Caution: Do not exceed 8.6 bar (125 psig) air supply pressure.

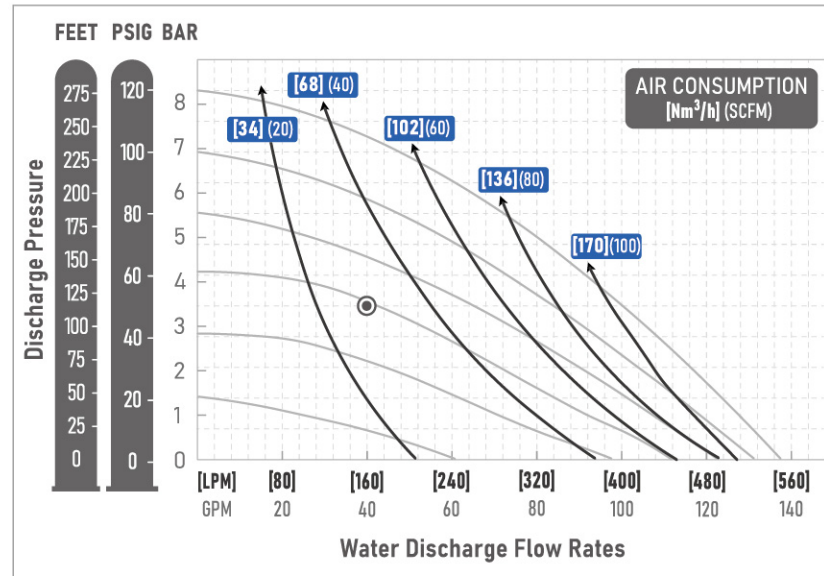

Flow rates indicated on chart were pumping water. For optimum life and performance, pumps should be specified so that daily operation parameters will fall in the center of the pump performance curve.

GT400 METAL PTFE-FITTED

Height ----- 606 mm (24")
 Width ----- 442 mm (17")
 Depth ----- 203 mm (8")
 Est. Ship Weight
 ----- Threaded Stainless 49 kg (110 lbs)
 ----- Flanged Stainless 52 kg (105 lbs)
 Air Inlet ----- 19 mm (3/4")
 Inlet ----- 38 mm (1 1/2")
 Outlet ----- 38 mm (1 1/2")
 Suction Lift ----- 4.9 m Dry (16')
 ----- 9.0 m Wet (30')

Disp. Per Stroke
 ----- 1.1 l (0.28 gal.)
 Max. Flow Rate ----- 480 lpm (128 gpm)
 Max. Size Solids ----- 6.4 mm (3/16")

Displacement per stroke was calculated at 4.8 bar (70 psig) air inlet pressure against a 2 bar (30 psig) head pressure.

Example: To pump 160 lpm (40 gpm) against a discharge pressure head of 3.5 bar (50 psig) requires 4.5 bar (70 psig) and 55 Nm³/h (35 scfm) air consumption. (See dot on chart.)

Caution: Do not exceed 8.6 bar (125 psig) air supply pressure.

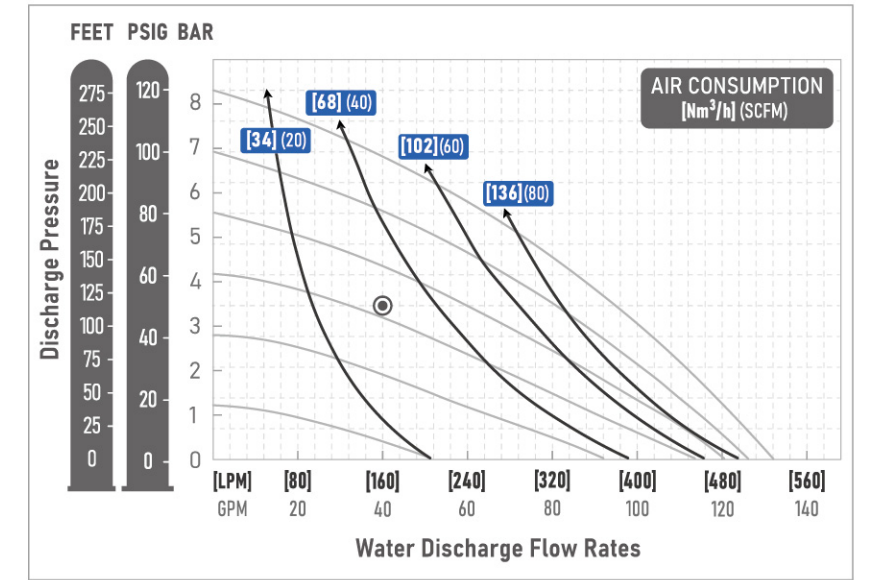

Flow rates indicated on chart were based on pumping water. For optimum life and performance, pumps should be specified so that daily operation parameters will fall in the center of the pump performance curve.

SUCTION LIFT CURVES

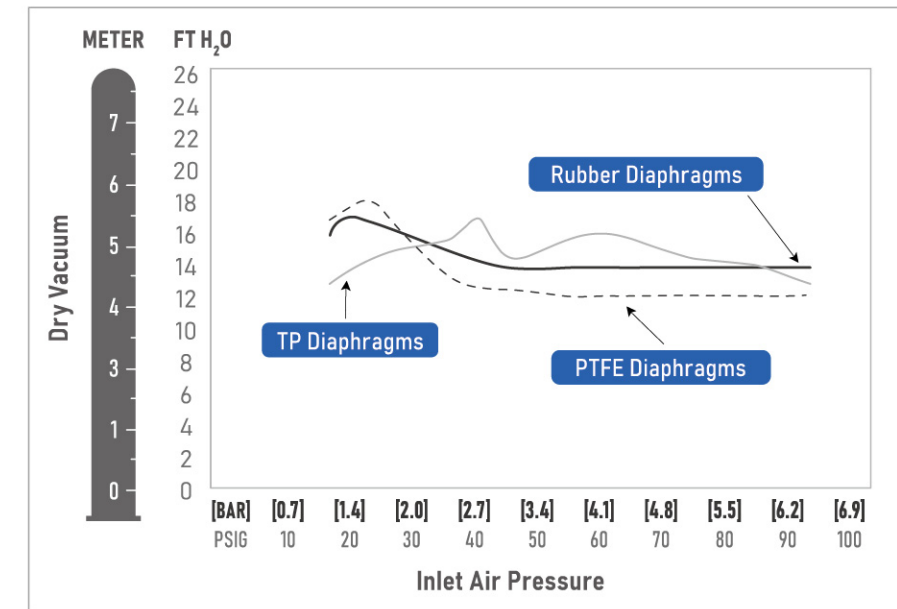

SECTION 5

The model GT400 Metal has a 38 mm (1 1/2 ") inlet and 38 mm (1 1/2 ") outlet and is designed for flows to 498 lpm (131 gpm). The GT400 Metal pump has only wetted parts with 316 stainless steel. The common center section of the GT400 Metal is constructed of virgin polypropylene. We also provide metal and conductive polypropylene materials (consult factory) to better service different requirements. A variety of diaphragms and o-rings are available to satisfy temperature, chemical compatibility, abrasion resistant and flex life.

The suction pipe size should be at least 38 mm (1 1/2 ") diameter or larger if viscous liquid is being pumped. The suction hose must be non-collapsible, reinforced type as the GT400 is capable of pulling a high vacuum. Discharge piping should be at least 38 mm (1 1/2 "), larger diameter in order to reduce friction losses. It is critical that all fittings and connections are air tight to avoid loss of pump suction capability.

INSTALLATION:

Premature failure and long term dissatisfaction can be avoided if reasonable care is carried out throughout the installation process.

LOCATION:

Factors such as noise, safety, and other logistical reasons normally dictate that "utility" equipment be situated away from the production floor. Multiple installations with conflicting requirements can result in congestion of utility areas, leaving few choices for siting of additional pumps. It is advisable every pump should be located in such a way that four key factors are balanced against each other to maximum advantage.

1.ACCESS:

Ensure that the pump locations are easily accessible in order to reduce the time used for the maintenance personnel carrying out routine inspections and adjustments. It helps to speed up the repair process and reduce total downtime especially when major repairs are required.

2.AIR SUPPLY:

To achieve a desired pumping rate, it is important to have an air line large enough to supply the required air volume to every pump location. (Refer to pump performance chart). Use air pressure up to a maximum of 8.6 bar (125 psig) depending on pumping requirements.

3.ELEVATION:

In order to eliminate loss-of-prime problems and not to affect pump efficiency, it is advisable to select a site location that is well within the dynamic lift capability of the pump.

SUGGESTED INSTALLATION

4.PIPING:

It is necessary to evaluate the piping problems of every possible piping location before the final selection of pump site location.

A site with a shortest and straightest hook-up of suction and discharging piping would be the best option when choosing a pump site. Ensure to avoid unnecessary elbows, bends and fittings. It is also important to select pipe sizes to keep the friction losses within limits. All piping to be supported independently of the pumps and piping must be aligned to reduce pump fitting placing problems.

Flexible hose can be installed to aid in absorbing the forces created by the natural pulsation of the pump. If the pump is to be bolted down to a solid location, a mounting pad placed between the pump and the foundation will assist in minimizing pump vibration. Flexible connections between the pump and rigid piping will also assist in minimizing pump vibration. If quick-closing valves are installed at any point in the discharge system, or if pulsation within a system becomes a problem, a Liquade LD1" Dampener should be installed to protect the pump, piping and gauges from surges and water hammer.

When pumps are installed in applications involving flooded suction or suction head pressures, a gate valve should be installed in the suction line to allow closing of the line for pump service.

The GT400 cannot be used in submersible applications.

For self-priming application, make sure that all connections are air tight and the suction lift is within the model's ability. Note: Materials of construction as well as elastomer material have an effect on suction lift parameters. Please consult Liquade distributors for specifics.

Pumps in service with a positive suction head are most efficient when inlet pressure is limited to 0.4–0.7 bar (7–10 psig). If the positive suction is 0.7 bar (10 psig) or higher, it may cause premature diaphragm failure.

THE MODEL GT400 WILL PASS 6.4 MM (3/16") SOLID. A STRAINER SHOULD BE USED ON THE SUCTION LINE TO AVOID LARGER SOLID OBJECTS SUCKED INTO THE PUMP.

CAUTION: DO NOT EXCEED 8.6 BAR (125 PSIG) AIR SUPPLY PRESSURE.

BLOW OUT AIR LINE FOR 10 TO 20 SECONDS BEFORE ATTACHING TO PUMP TO MAKE SURE ALL PIPE LINE DEBRIS IS CLEAR.

▲ The GT pump is not submersible

SECTION 6

TROUBLESHOOTING

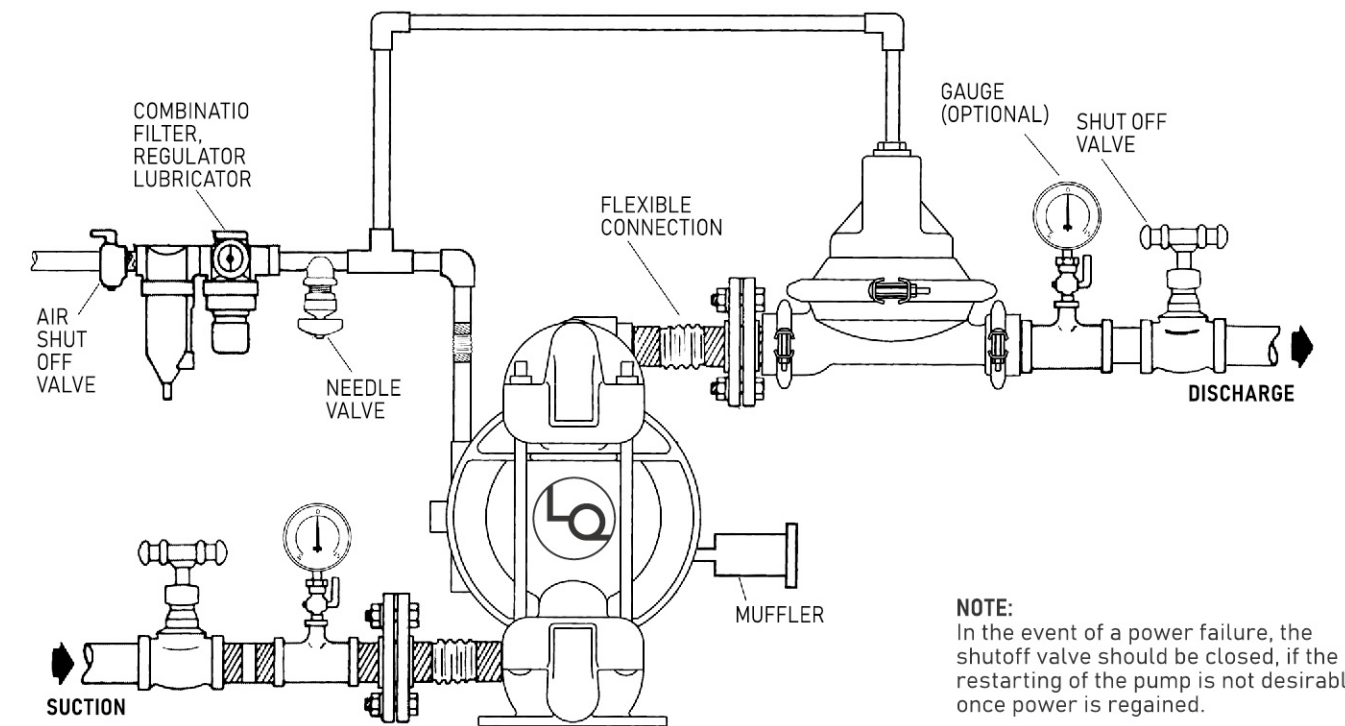

NOTE: In the event of a power failure, the shutoff valve should be closed, if the restarting of the pump is not desirable once power is regained.

AIR-OPERATED PUMPS:

To stop the pump from operating in an emergency situation, simply close the "shut-off" valve (user supplied) installed in the air supply line. A properly functioning valve will stop the air supply to the pump, therefore stopping output. This shut-off valve should be located far enough away from the pumping equipment such that it can be reached safely in an emergency situation.

Pump does not run or runs slowly.

1. Ensure that the air inlet pressure is at least 5 psig above startup pressure and that the differential pressure (the difference between inlet and discharge pressure) to be more than 10 psig.
2. Check air inlet filter for particles (see recommended installation).
3. Check if there is extreme air leakage which would indicate worn out seals/bores.
4. Dismantle pump to inspect for obstructions in the air passageways or objects which would hinder the movement of internal parts.
5. Check for sticking valve ball. Swelling may occur if pumping liquid is not compatible with pump elastomers. Replace valve ball and seals with proper elastomers. Also, as valve balls wear out, they become smaller and can become stuck in the seats. In this case, replace both balls and seats.

Pump air valve freezes.

1. Check for excessive moisture in compressed air. Either install a dryer or hot air generator for compressed air. Alternatively, a coalescing filter may be used to remove the water from the compressed air in some applications.

Pump rattles.

1. Create false discharge head or suction lift.

Pump runs but little or no liquid flows

1. Check for pump cavitation; slow down the pump speed match the viscosity of the pumping liquid.
2. Verify the vacuum required to lift liquid is not greater than the vapor pressure of the material being pumped (cavitation).
3. Check for sticking valve ball. Swelling may occur if pumping liquid is not compatible with pump elastomers. Replace valve ball and seals with proper elastomers. Also, as the valve balls wear out, they become smaller and can become stuck in the seats. In this case, replace both balls and seats.
4. Ensure all inlet connections are tight, especially on the lower valve ball retainers.

Air bubbles found in pump discharge.

1. Check for ruptured failures.
2. Check tightness of outer pistons.
3. Check tightness of clamp bands and integrity of o-rings and seals, especially at inlet manifold.
4. Ensure pipe connections are air tight

Liquid leakage from air exhaust. (Muffler)

1. Check for diaphragm rupture.
2. Check tightness of pistons to shaft.

SECTION 7

PUMP DISASSEMBLY

CAUTION: Before perform any maintenance or repair, disconnect the compressed air line to the pump to allow all air pressure to bleed from pump. Disconnect all inlet, discharge, and air lines. Drain the pump by turning it upside down and allowing any fluid to flow into a suitable container. Wet flushing of parts may be required prior to handling.

TOOLS REQUIRED:

- 13 mm (1/2") Wrench
- 2 - 25 mm (1") Sockets or Adjustable Wrench Vise equipped with soft jaws (such as plywood, plastic or other suitable material)

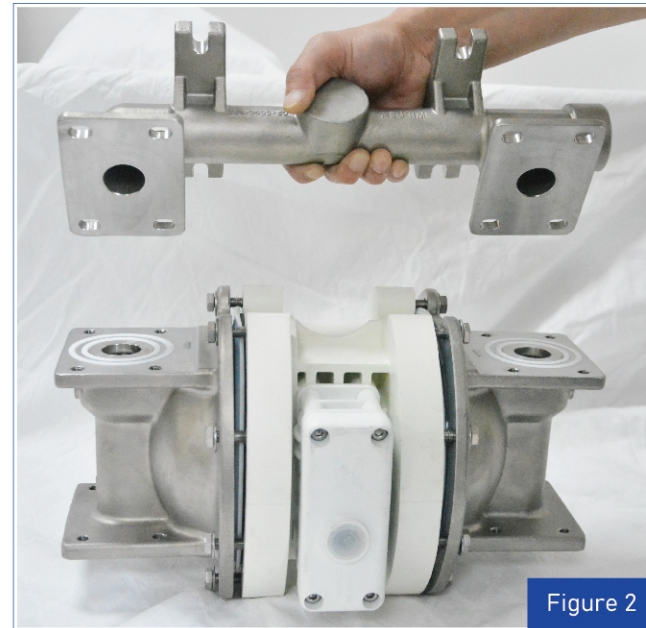

Step 2.
Lift the discharge manifold , Inspect the ball cage area of the manifold for excessive wear or damage.

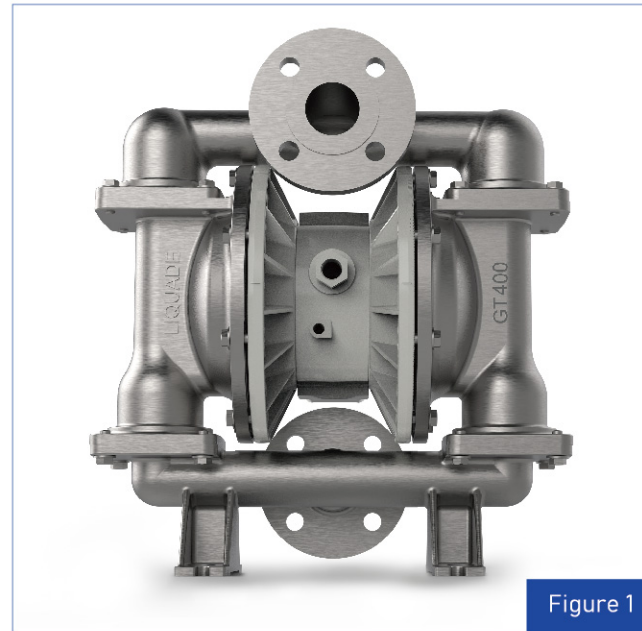

Figure 1

DISASSEMBLY:

Step 1.

Before carry out disassembly, drain all remaining fluid in the pump into a suitable container by turning it up-side down. Take extra caution if the liquid is corrosive or toxic.



Step 3.
Remove the discharge valve balls and valve seats, inspect for nicks, gouges, chemical attack or abrasive wear. Replace worn parts with genuine LIQUADE parts for reliable performance.

SECTION 7

PUMP DISASSEMBLY



Figure 4

Step 4.

Remove the discharge valve balls and valve seats, if necessary Replace worn parts with genuine LIQUADE parts for reliable performance.

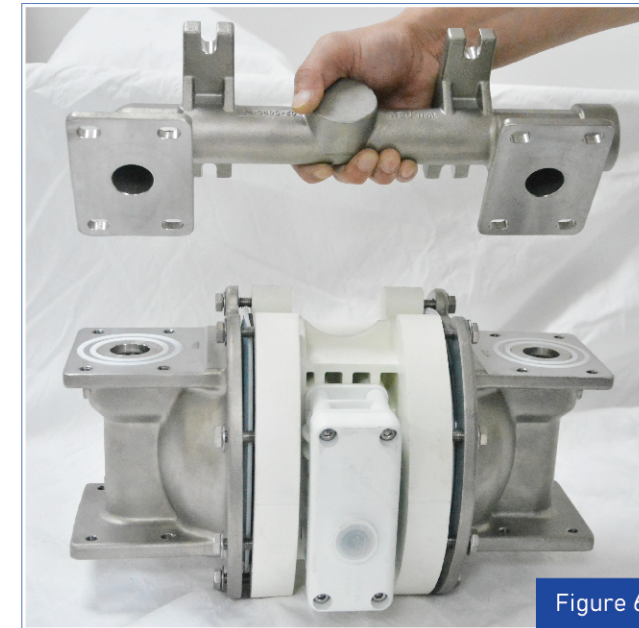

Step 6.
Remove the inlet manifold, check the valve balls and valve seats.

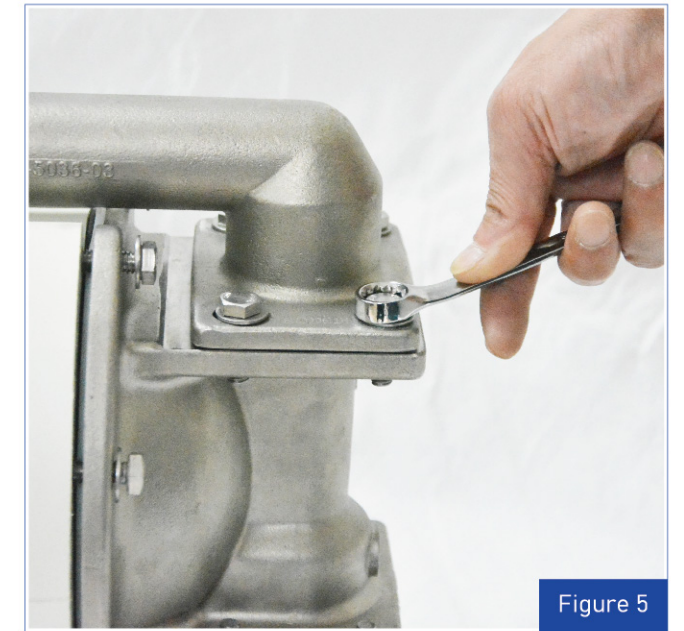

Figure 5

Step 5.

Using the appropriate-sized wrench, loosen the inlet manifold from the liquid chambers.



Figure 7

Step 7.
Remove the inlet valve balls and valve seats,check the nicks, gouges, chemical attack or abrasive wear.

SECTION 7

PUMP DISASSEMBLY

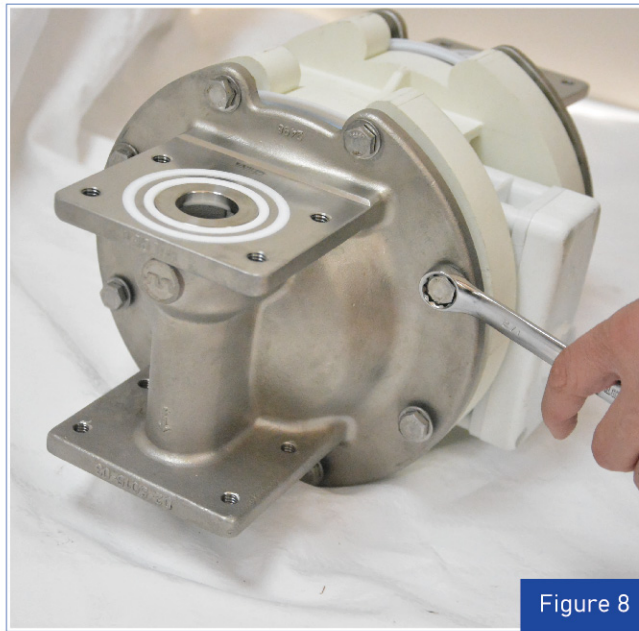

Figure 8

Step 8.

Using the appropriate-sized wrench, remove the liquid chamber from the center section.

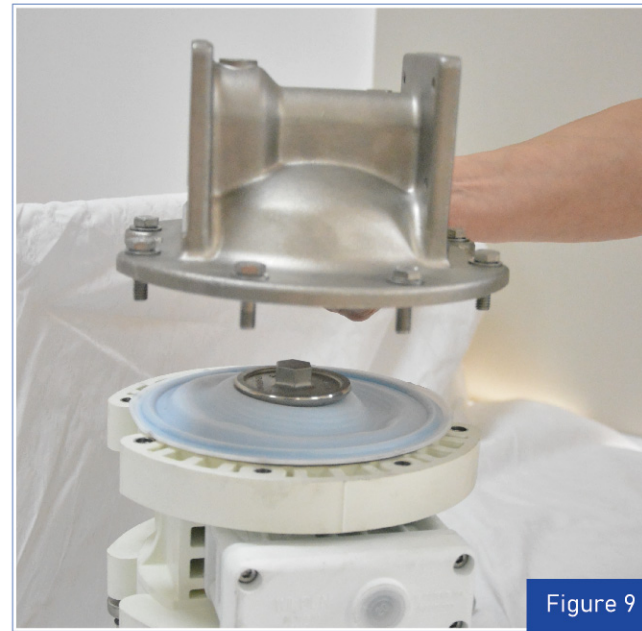

Figure 9

Step 9.

Remove the liquid chamber, expose the diaphragm and outer piston with an adjustable wrench.



Figure 10

Step 10.

After loosening and removing the outer piston, the diaphragm assembly can be disassembled.

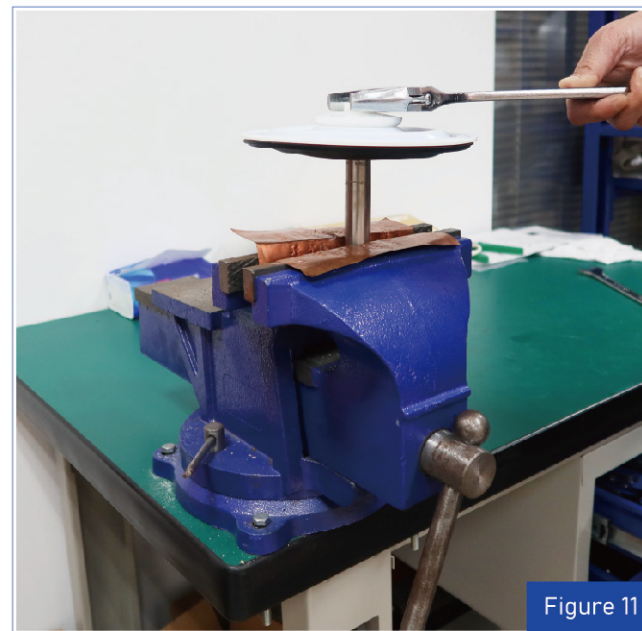

Figure 11

Step 11.

remove diaphragm assembly from shaft, secure shaft with soft jaws, ensure shaft is not nicked, scratched or gouged. Using an adjustable wrench, remove diaphragm assembly from shaft.

SECTION 7

AIR VALVE / CENTER SECTION DISASSEMBLY

AIR VALVE DISASSEMBLY:

CAUTION: Before perform any maintenance or repair, disconnect the compressed air line to the pump to allow all air pressure to bleed from pump. Disconnect all inlet, discharge, and air lines. Drain the pump by turning it upside down and allowing any fluid to flow into a suitable container. Be careful of dangerous effects of contact with the process fluid.

The Liquade Plastic GT200 metal utilizes an advance air distribution system. A 6 mm (1/4") air inlet connect the air supply to the center section. Composite seals reduce the coefficient of friction and allow the GT200 to run lube-free. Constructed of polypropylene, the air distribution system is designed to perform in on/off function, non-freezing, non-stalling and tough duty application.

TOOLS REQUIRED:

- 3/16" Allen Wrench
- Snap Ring Pliers
- O-Ring Pick

CAUTION:

Before carry out disassembly, drain all remaining fluid in the pump into a suitable container by turning it up-side down. Take extra caution if the liquid is corrosive or toxic.



Figure 1

Step 1.

Loosen the air valve bolts utilizing a 3/16" Allen wrench.



Figure 2

Step 2.

Remove muffer plate and air valve bolts from air valve assembly exposing muffer gasket for inspection. Replace if necessary.

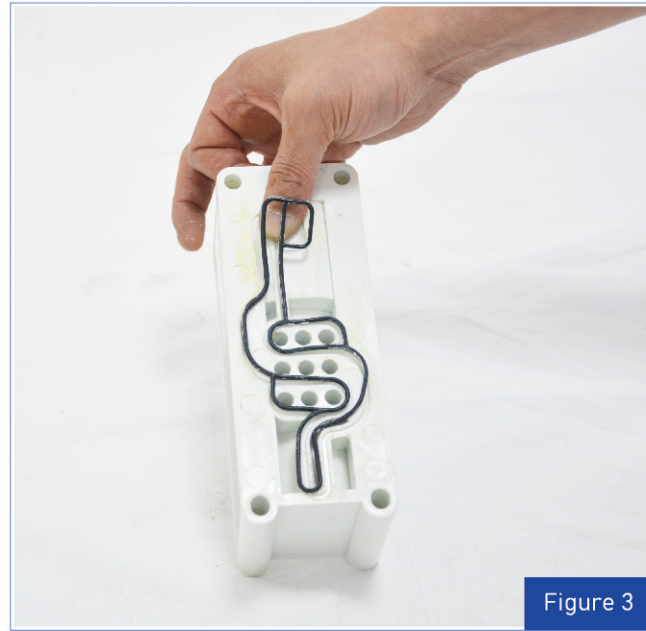

Figure 3

Step 3.
Lift away air valve and remove air valve gasket for inspection. Replace with Liquade gasket for reliable performance.



Figure 4

Step 4.
Remove the end cap to expose air valve spool by simply lifting up on end cap once air valve bolts are removed.



Figure 5

Step 5.
Remove air valve spool from air valve body by threading one air valve bolt into the end of the spool and gently sliding the spool out of the air valve body. Check the signs of the wear, replace the spool if necessary. The wear seals are not sold by separately.



Figure 6

Step 6.
Remove pilot spool sleeve retaining snap ring on both sides of center section with snap ring pliers, and lift up pilot spool sleeve from center section.

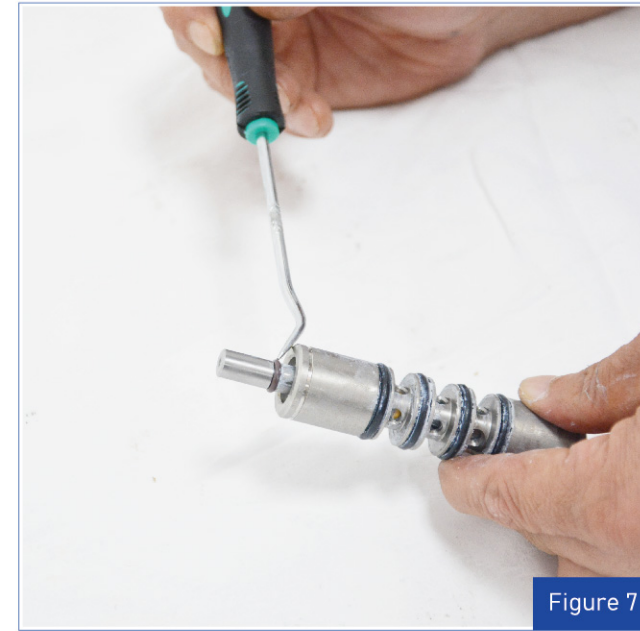

Figure 7

Step 7.
Gently remove the o-ring with o-ring pick from the opposite side of the "center hole" cut on the spool. Check the signs of wear, Replace pilot sleeve assembly for reliable performance.

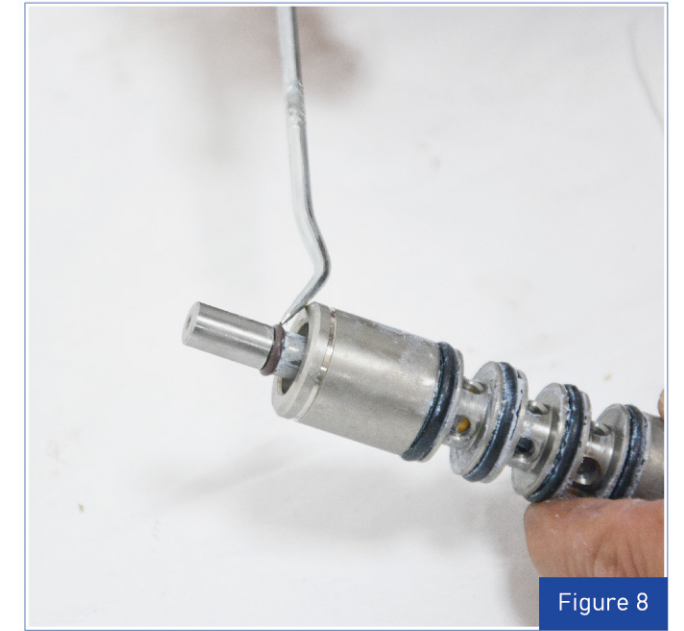

Figure 8

Step 8.
Check center section Glyd rings for signs of wear. Replace the Liquade Glyd rings for reliable performance.

Reassembly Hints & Tips

The following tips will assist in the assembly process.

- 1 For reassembly, please refer to disassemble process in reverse order.
- 2 Clean the center section shaft before assembly, make sure no damage for the Glyd rings.
- 3 Lube all the stainless bolts before tightening.
- 4 Using proper torque values to tighten the outer piston, check these values below chart.
- 5 Apply two drops of Loctite® 246 to the shaft internal threads before the diaphragm assembly.

TORQUE SPECIFICATIONS FOR MODEL GT400 METAL PUMP

Description of Part	Torque
Air Valve	5.1 N•m (45 in-lbs)
Air Chamber/Center Block	27.1 N•m (20 ft-lbs)
Liquid Chamber/Air Chamber, Aluminum Bolted Only	47.5 N•m (35 ft-lbs)
Liquid Chamber/Air Chamber, Stainless Steel Bolted Only	17.6 N•m (13 in-lbs)
Liquid Chamber to Air Chamber, Aluminum	54.2 N•m (40 in-lbs)

SECTION 8

EXPLODED VIEW & PARTS LISTING

GT400 METAL

EXPLODED VIEW

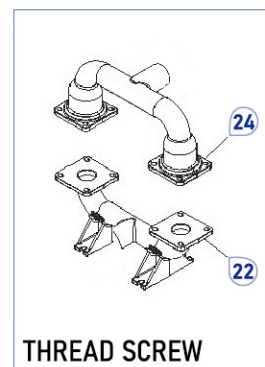
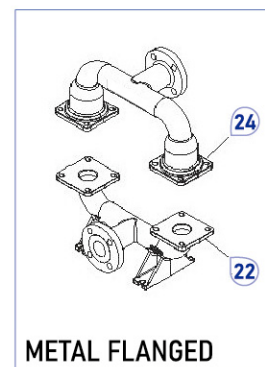
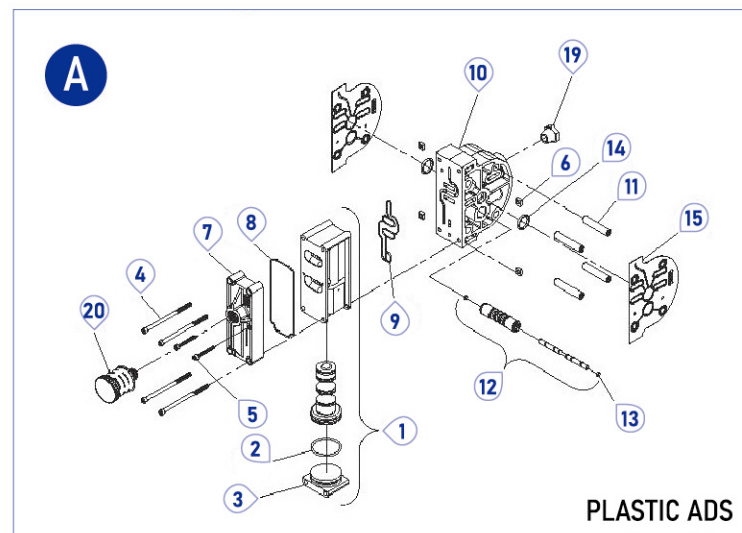
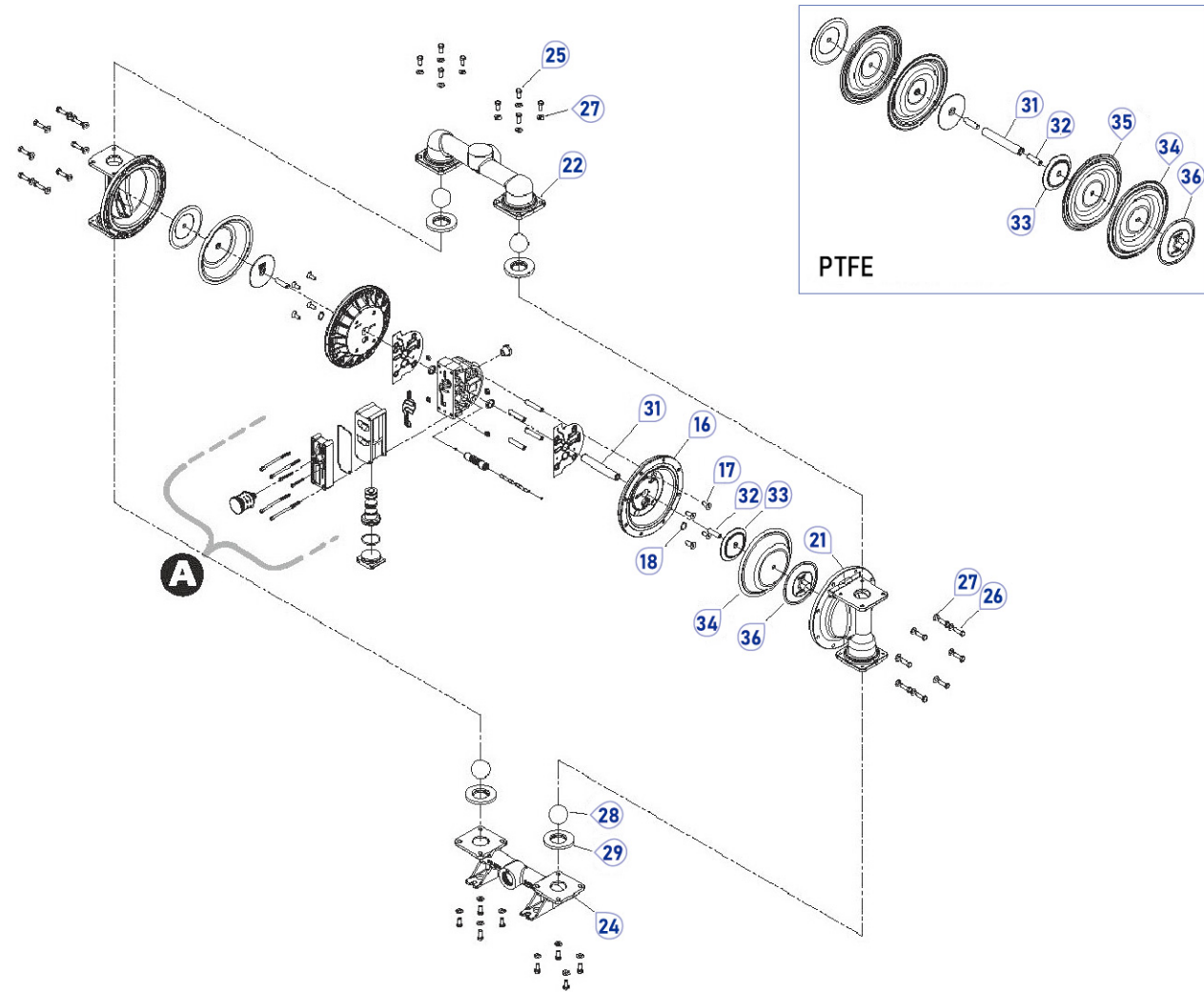

SECTION 8

EXPLODED VIEW & PARTS LISTING

GT400 METAL

PARTS LISTING

Item #	Description	Qty Per Pump	GT400-SPP	GT400X-SPP
Air Distribution Components				
1	Air Valve Assembly	1	L04-2000-20-700	L04-2000-20-700C
2	O-Ring, End Cap (-225, Ø1.859" x Ø.139")	1	L04-2390-52-700	L04-2390-52-700
3	End Cap	1	L04-2330-20-700	L04-2330-20-700C
4	Screw, SHC, Air Valve (1/4"-20 x 4-1/2")	4	L01-6000-03	L01-6000-03
5	Screw, Self Tapping, SHC (10-16 x 1-3/4")	2	L04-6351-03	L04-6351-03
6	Nut, Square (1/4"-20)	4	L00-6505-03	L00-6505-03
7	Muffler Plate,	1	L04-3180-20-700	L04-3180-20-700C
8	Gasket, Muffler Plate	1	L04-3500-52-700	L04-3500-52-700
9	Gasket, Air Valve	1	L04-2600-52-700	L04-2600-52-700
10	Center Block Assembly	1	L04-3110-20	L04-3110-20C
11	Sleeve, Threaded, Center Block	4	L04-7710-08	04-7710-08
12	Pilot Sleeve Assembly	1	L04-3880-99	04-3880-99
13	O-Ring, Pilot Spool Retaining	2	L04-2650-49-700	04-2650-49-700
14	Seal, Shaft	2	L08-3210-55-225	08-3210-55-225
15	Gasket, Center Block	2	L04-3526-52	L04-3526-52
16	Air Chamber	2	L04-3681-01	L04-3681-01
17	Screw, HSFHS (3/8"-16 x 1")	8	L71-6250-08	L71-6250-08
18	Retaining Ring	2	L04-3890-03	L04-3890-03
19	Bushing, Reducer 3/4" MNPT to 1/2" FNPT	1	L04-6950-20-700	L04-6950-20-700
20	Muffler 3/4" MNPT	1	L04-3510-99	L04-3510-99
Wetted Path Components				
21	Liquid Chamber	2	L04-5015-03	L04-5015-03
22	Manifold, Discharge, 1-1/2" (NPT)	1	L04-5056-03	L04-5056-03
	Manifold, Discharge, 1-1/2" (BSPT)	1	L04-5055-03	L04-5055-03
	Manifold, Discharge, 1-1/2" (ANSI)	1	L04-5045-03	L04-5045-03
	Manifold, Discharge, 1-1/2" (DIN)	1	L04-5046-03	L04-5046-03
24	Manifold, Inlet, 1-1/2" (NPT)	1	L04-5136-03	L04-5136-03
	Manifold, Inlet, 1-1/2" (BSPT)	1	L04-5135-03	L04-5135-03
	Manifold, Inlet, 1-1/2" (ANSI)	1	L04-5125-03	L04-5125-03
	Manifold, Inlet, 1-1/2" (DIN)	1	L04-5126-03	L04-5126-03
25	Screw, HHC (3/8"-16 x 1")	16	L08-6130-03	L08-6130-03
26	Screw, HHC (3/8"-16 x 1-1/4")	16	L04-6140-03	L04-6140-03
27	Washer, Flat, (Ø.406" x Ø.812" x .065")	32	L04-6740-03	L04-6740-03
Valve Balls/Valve Seats/Valve O-Rings				
28	Ball, Valve	4	*	*
29	Seat, Valve	4	*	*
30	Valve Seat O-Ring, PTFE-Fitted (-338, Ø3.100" x Ø.210") (not shown)	4	L71-1281-55	L71-1281-55
PTFE/Rubber/TP Components				
31	Shaft	1	L04-3800-03-700	L04-3800-03-700
32	Shaft Stud 1/2"-20 x 1-7/8"	2	L08-6150-08	L08-6150-08
33	Piston, Inner	2	L04-3700-01-700	L04-3700-01-700
	Diaphragm	2	*	*
	Diaphragm, Backup	2	*	*
36	Piston, Outer	2	L04-4550-03	L04-4550-03

*Refer to Elastomer Options in Section 9.

¹ Air Valve Assembly includes items 2, 3.

GT400 METAL

Material	Diaphragms (2)	Backup Diaphragms (2)	Valve Ball (4)	Valve Seats (4)	Valve Seat O-Ring (4)
Neoprene	L04-1010-51		L08-1080-51-50	L04-1128-51	
Buna-N®	L04-1010-52		L08-1080-52-50	L04-1128-52	
EPDM	L04-1010-54		L08-1080-54-50	L04-1128-54	
FDA EPDM	L04-1010-74				
FKM	L04-1010-53		L08-1080-53-50	L04-1128-53	
PTFE	L04-1040-55	L04-1065-57	L04-1085-55		L71-1281-551
Saniflex	L04-1022-56		L08-1080-56-50	L04-1128-56	
Wilflex-FDA	L04-1022-57			L04-1128-57	
Wilflex	L04-1022-58		L08-1080-58-50	L04-1128-58	
Stainless Steel				L04-1129-03	

All products by LIQUADE are built to meet the highest standards of quality and are guaranteed to be free from defects in material and workmanship for a period of five (5) years from date of installation or six (6) years from date of manufacture, whichever comes first. Failure due to wear and tear or misapplication, shall be excluded from this warranty. Warranty shall be deemed void if unauthorized modifications are made to the pump or serviced by unauthorized LIQUADE personnel or partners.

LIQUADE cannot guarantee the suitability of the pump or parts for any particular application. In addition, LIQUADE shall not be liable for consequential damage or expense arising from the use or misuse of its products on any application. Warranty is limited to replacement or repair of the pump or part at the factory or at a point designated by LIQUADE.

Prior approval must be obtained from LIQUADE for return of any product for warranty consideration and must be accompanied by the legitimate MSDS for the product(s) involved. Also, this warranty does not obligate LIQUADE to bear the cost of labour or transportation charges in connection with replacement or repair of defective pumps/parts.

All investigation as to the cause of failure of the pump shall be solely determined by Liquade and its decision deemed final.

This warranty is in lieu of all other warranties and conditions expressed or implied, written or oral, statutory to the extent allowable by law or otherwise, which are hereby negated and excluded.

PLEASE FILL OUT THE FORM BELOW AND RETURN BY FAX OR EMAIL

PUMP INFORMATION				
Item #		Serial#		
Company Where Purchased				
YOUR INFORMATION				
Company Name				
Industry				
Name			Title	
Street address				
City	State	Postal Code	Country	
Telephone	Fax	E-mail	Website	
Number of pumps in facility? _____		Number of Liquade pumps? _____		
Types of pumps in facility (check all that apply) <input type="checkbox"/> Diaphragm <input type="checkbox"/> Centrifugal <input type="checkbox"/> Gear <input type="checkbox"/> Submersible <input type="checkbox"/> Submersible				
<input type="checkbox"/> Others (please indicate) _____				
Media being pumped _____				
How did you hear of Liquade Pump? <input type="checkbox"/> Trade Journal <input type="checkbox"/> Trade Show <input type="checkbox"/> Internet/Email <input type="checkbox"/> Distributor				
<input type="checkbox"/> Others (please indicate) _____				